

\$3,890,000 - 65 Ave Rr 245&250, Rural Leduc County

MLS® #E4393540

\$3,890,000

0 Bedroom, 0.00 Bathroom,
Rural on 59.80 Acres

None, Rural Leduc County, AB

APP 59.8 ACRES(MORE OR LESS).LOCATED ON 65 AVE BETWEEN RR 245 AND 250.PARCEL IS LOCATED IN LEDUC COUNTY AND HAS A GREAT POTENTIAL IN SAUNDERS LAKE AREA STRUCTURE PLAN.FUTURE PROPOSED ZONING IS MEDIUM INDUSTRIAL.

Essential Information

MLS® #	E4393540
Price	\$3,890,000
Bathrooms	0.00
Acres	59.80
Type	Rural
Sub-Type	Vacant Lot/Land
Status	Active

Community Information

Address	65 Ave Rr 245&250
Area	Rural Leduc County
Subdivision	None
City	Rural Leduc County
County	ALBERTA
Province	AB
Postal Code	T9E 4C4

Exterior

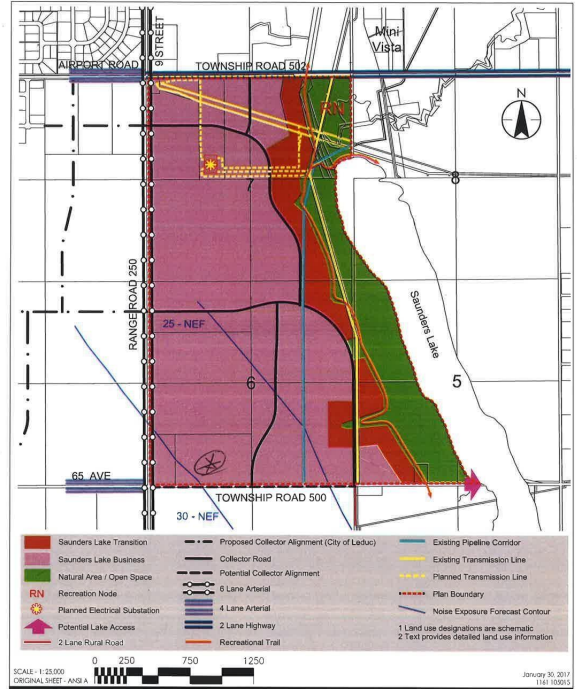

10160-112 Street
Edmonton, AB T5K 2L6
www.stantec.com

Client/Project
SAUNDERS LAKE INDUSTRIAL PARK LTD.
NORTHWEST SAUNDERS LAKE
LOCAL AREA STRUCTURE PLAN
Figure No.
4.0
Title
DEVELOPMENT
CONCEPT

Exterior Features See Remarks

Additional Information

Date Listed June 19th, 2024

Days on Market 289

Zoning Zone 80

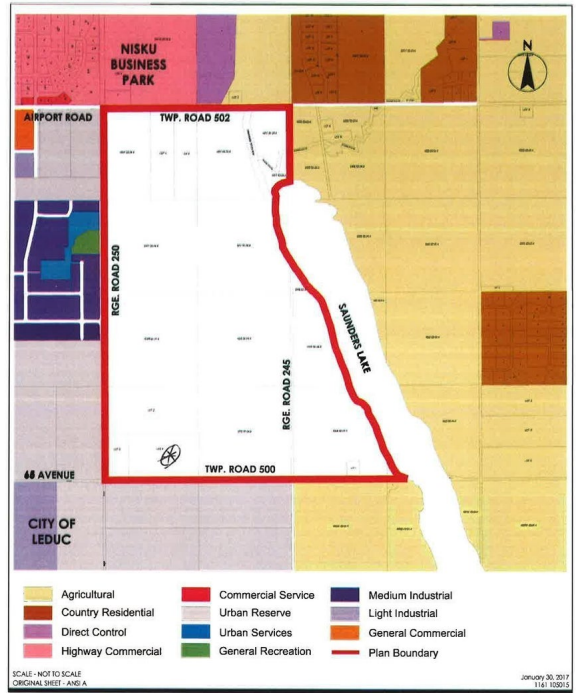

10160-112 Street
Edmonton, AB T5K 2L6
www.stantec.com

Client/Project
SAUNDERS LAKE INDUSTRIAL PARK LTD.
NORTHWEST SAUNDERS LAKE
LOCAL AREA STRUCTURE PLAN
Figure No.
2.0
Title
PLAN BOUNDARY AND
ADJACENT USES

DATA IS DEEMED RELIABLE BUT IS NOT GUARANTEED ACCURATE BY THE REALTORS[®] ASSOCIATION OF EDMONTON. COPYRIGHT 2025 BY THE REALTORS[®] ASSOCIATION OF EDMONTON. ALL RIGHTS RESERVED. Trademarks are owned or controlled by the Canadian Real Estate Association (CREA) and identify real estate professionals who are members of CREA (REALTOR[®], REALTORS[®]) and/or the quality of services they provide (MLS[®], Multiple Listing Service[®])
Listing information last updated on April 4th, 2025 at 9:18am MDT

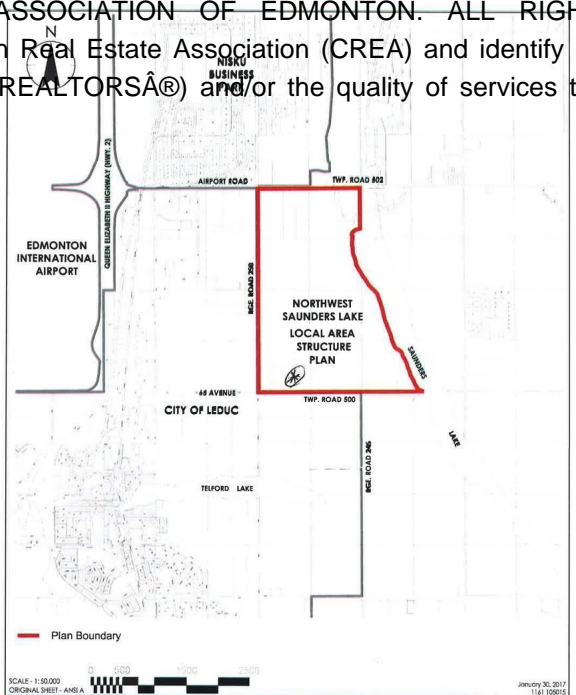

10160-112 Street
Edmonton, AB T5K 2L6
www.stantec.com

Client/Project
SAUNDERS LAKE INDUSTRIAL PARK LTD.
NORTHWEST SAUNDERS LAKE
LOCAL AREA STRUCTURE PLAN
Figure No.
1.0
Title
PLAN LOCATION